

USER MANUAL



(KR-140)

1. Product Instruction

1.1 Appearance and components:

1.1.1 Front panel



1.1.2 Lock body



KR-140-1 blade type locks body



KR-140-2 retractable type locks body



KR-140-3 rocker type locks body

1.2 Dimension:

1.2.1 Dimension of front panel:

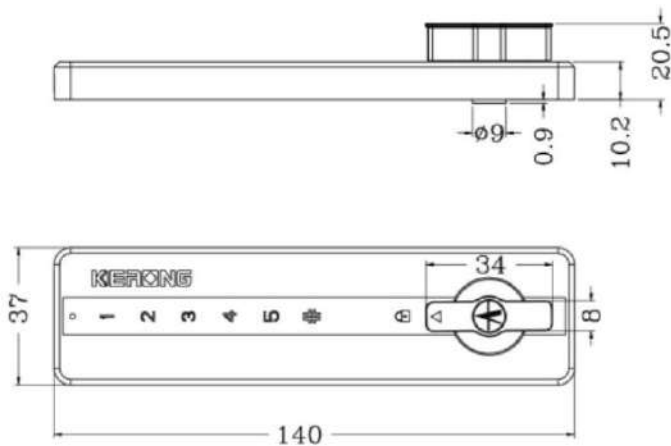

1.2.2 Dimension of lock body

1.2.2.1 KR-140-1 blade type lock body

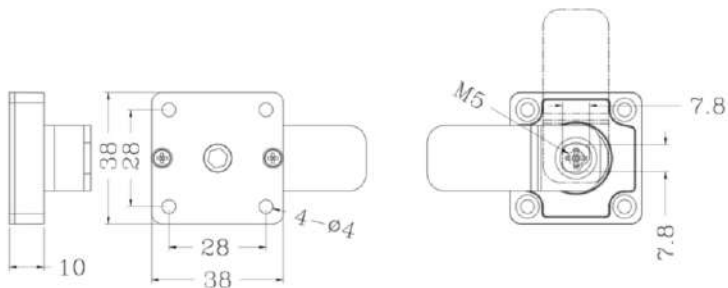

Type: KR-140-1 Material: Zinc alloy +Cold-rolled steel
Surface treatment: matted chrome plating

1.2.2.2 KR-140-2 retractable type lock body

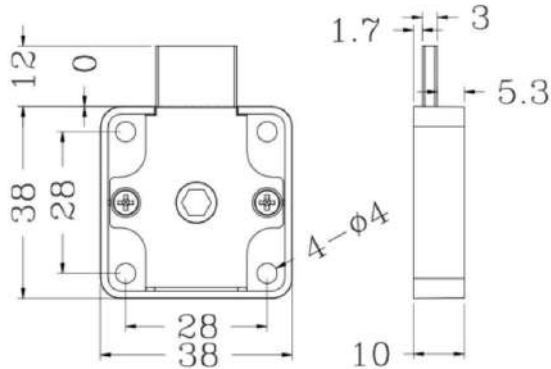

Type: KR-140-2 Material: Zinc alloy +Cold-rolled steel
Surface treatment: matted chrome plating

1.2.2.3 KR-140-03 rocker type lock body

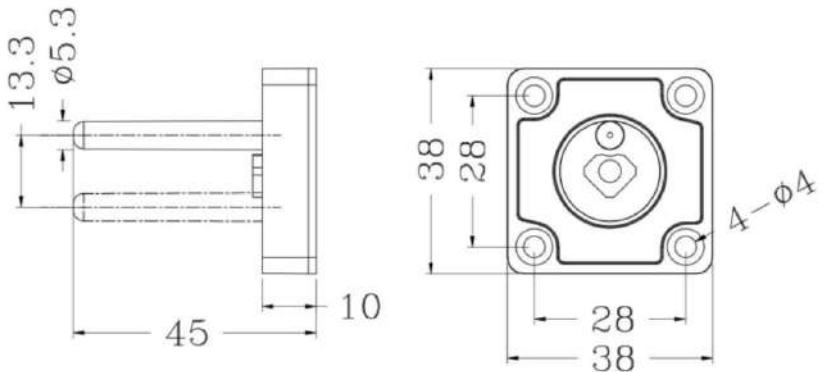

Type: KR-140-3 Material: Zinc alloy +Cold-rolled steel
Surface treatment: matted chrome plating

BENZOVILLE

HARDWARE

1.2.3 Drawing of Installation holes in door:

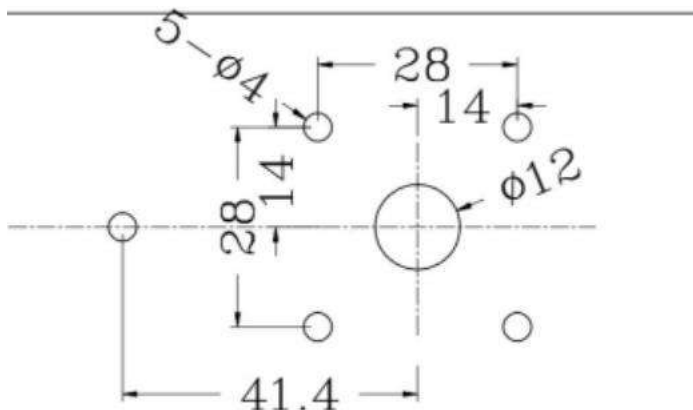

1.2.4 Instruction of installation:

2 Product functions

| | Functions | Factory settings | usage | Note |
|-----------------|-------------------------|------------------|------------------------------------|--|
| Code management | User code | 1111 | User can change code of 4~8 digits | If forget user code, manage code can unlock as well. If forget manage code, User can apply for OTP to unlock. After using management code or OTP, lock will |
| | Management code | 5555 | | |
| | OTP (one time password) | <u>Standard</u> | Software generate OTP | |

BENZOVILLE

HARDWARE

| | function | | automatic ally | return to factory default setting. |
|-----------------|--|--|-------------------|---------------------------------------|
| | Messy code protection | 1、 User can input any random numbers (before and after) of the full correct code to unlock, as long as the correct code is sequential. 2、 The total code should be less than 20 digits. | | |
| | Lock function after wrong code | It will be locked for 5 minutes if input wrong code for 5 times, During this period, any operation is useless only along with red light blink . | | |
| Sound remind | Keyboard sound | Any input of the keyboard will make a “di” sound. | | |
| | Correct code | Every time after input correct code, it will make a long “di--”sound. | | |
| | Wrong code warning | Every time after input the wrong code, it will make warning“di, di, di” sound. | | |
| | Change code | After change code successfully, it will make a long “di---”sound | | |
| | Stand-by mode | 3 seconds without operation, it will make a “du” sound and enter into stand-by mode automatically | | |
| | Initializat | After initializing, it will make“di, di”sound | | |

BENZOVILLE

HARDWARE

| | | | | |
|----------------------------------|---------------------------|---|--|--|
| | ion sound | | | |
| | Low voltage warning | After operation/before enter into stand-by mode, it will make “di, di, di di”sound | | |
| Light remind functio n | Code correct | Green light will be on for 1 second | | |
| | Code wrong | Red light blink 3 times/s | | |
| | Change code | successfu lly | Green light will be on for 1s | |
| | | failed | Red light blink 3 times | |
| | Low voltage | Every time after operation/before enter into stand-by mode, both lights blink twice; | | |
| Syste m mana geme nt | Initializatio n | <u>Standard configur ation</u> | 1.Press initialization button to reset 2、 All codes and settings will be back to factory setting after initialization. | |
| | OTP system | <u>Standard equipme nt</u> | 1、 Customer can use the OTP system by themselves. 2、 Customer need to have the uniform Background Server or Terminal system. | |
| Powe | Battery | International standard CR2032 /3V button | | |

BENZOVILLE

HARDWARE

| | | | |
|---------------------|--|---|--|
| r suppl y | | battery, stand-by time is more than 1 year | |
| | Extension Battery box | <u>Optional</u> | Can extend power supply as customer required, extend lifetime of battery; Need to add an extra battery box for power supply. |
| Work ing Mode | Private mode | Change to Private mode: “##4#”-management password- “#” | Factory default setting is Private mode. |
| | Public mode | Change to Public mode: “##5#”-management password- “#” | |
| struc ture | Clutch | Servo clutch with lower power consumption , support servo “reversing” | With utility model patent |
| | Emergency open (mechanical key) | <u>Optional</u> | 1.Mechanical lock can be placed in the knob position for emergency use. 2.The key can be one master key or independent key. |

3 Technical parameters

| | Name | Material/Finish | Parameter | Configuration |
|--|-------------|-------------------|-------------|---------------|
| | Front panel | Zinc alloy& pearl | Salt spray | Weight:126g |
| | Rotary knob | chrome plated | test for 96 | |

BENZOVILLE

HARDWARE

| | | | | |
|----------------------------|---------------------|---|---------------|--|
| Structure parameters | Lock body | | hours | Weight:56g |
| | Torsion of knob | > 120 kgs | | |
| | Door thickness | Suit for steel door, wooden door, and ABS door etc. Door thickness: 1.0~30.0mm | | |
| Electronic parameter | Battery | CR2032(cell battery) | 3V | 1 PCS |
| | Static current | | <10UA | Working life under stand-by mode:2 years |
| | Dynamic current | | <30MA | Unlock times: > 5000 times |
| | Working temperature | | -15~ +65°C | |
| | Working humidity | | 5~95% | |
| | Low voltage alarm | | <2.45V | Can work 200 times after alarm. |
| Electrostatic interference | Touch discharge | | >6KV | |

BENZOVILLE

HARDWARE

| | | | | |
|--|-----------------------|--|------|--|
| | Anti-air discharge | | >8KV | |
|--|-----------------------|--|------|--|

4 Installation & Test

4.1 Installation

4.1.1 Install according to the "Installation Instruction";

4.1.2 After installing, please test the lock.

4.1.3 Warm tips: Please test the whole lock and confirm it can work well

Before close the door.

4.2 Test procedure:

4.2.1 "Private mode" unlocking test:

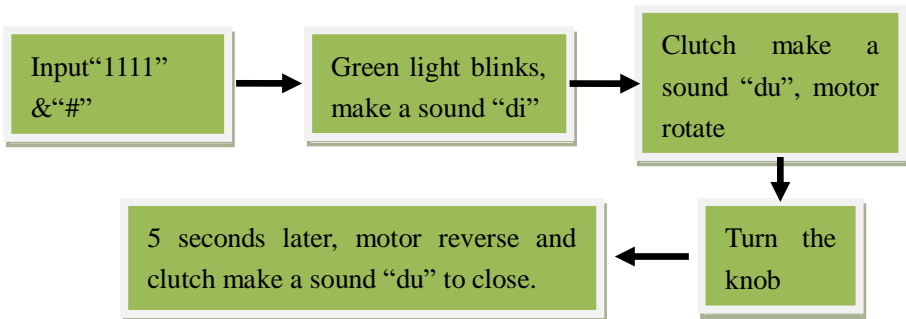

4.2.2 "Private mode" locking test:

Turn the knob, latch stuck in lock position----locked

4.2.3 "Private mode" locking test:

BENZOVILLE

HARDWARE

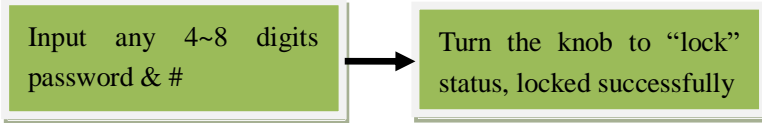

4.2.2 "Private mode" unlocking test:

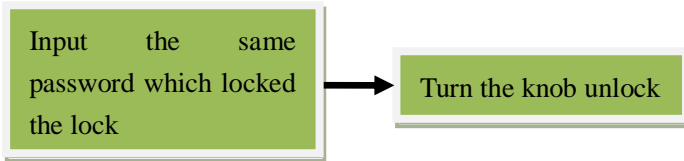

5. Operation process

5.1 Change code:

5.1.1 Change user code:

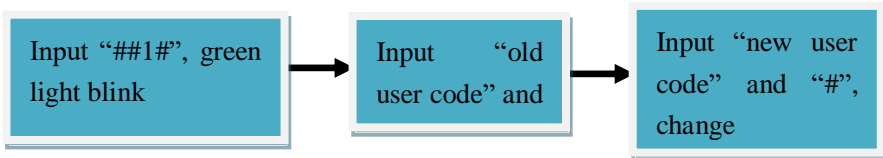

5.1.2 Change management code:

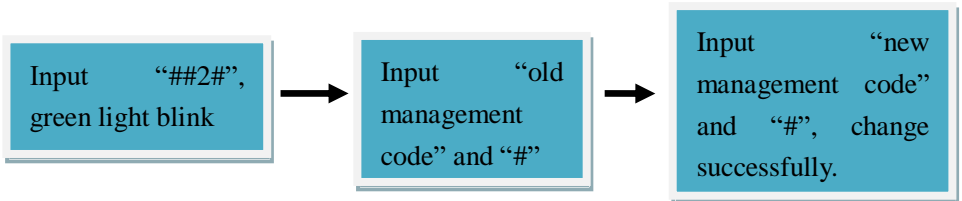

5.1.3 Public mode is without certain user password, password is only valid for one operation: input any code for locking, then input the same code for unlocking.

5.2 Initialize:

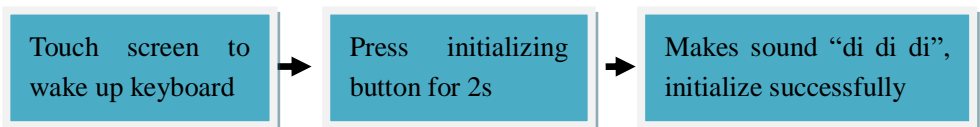

5.3 OTP system

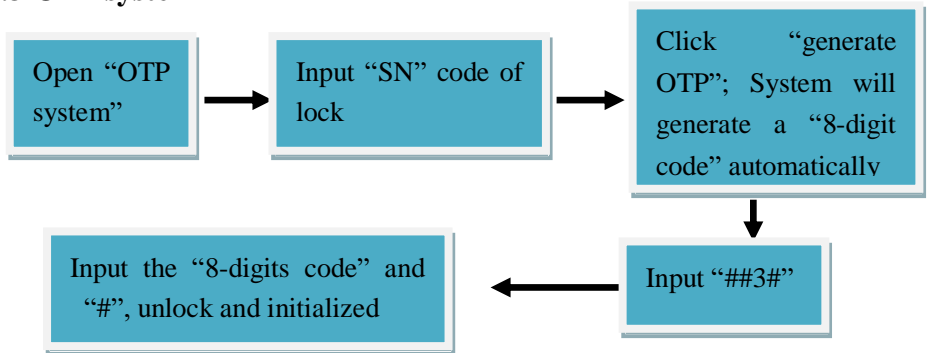

5.4 Solutions for common Fault

5.4.1 Out of power:

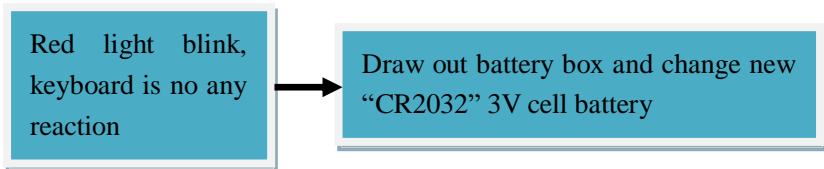

5.4.2 Forget user code:

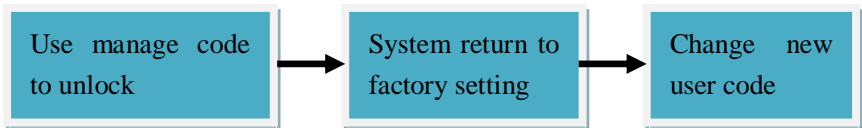

5.4.3 Forget manage code:

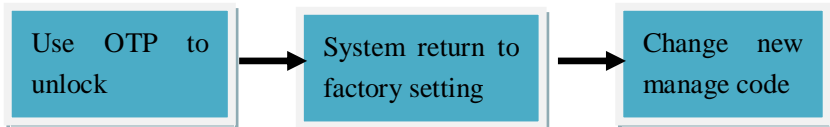

BENZOVILLE
HARDWARE

BENZOVILLE
HARDWARE

ADD: 59-B, Arjun Nagar, Timber Market
(Near Jawala Prasad & Co.)
Opp. Defence Colony, New Delhi – 110003
Tel: +91-11-24655704, 41554595
Website: <http://www.benzoville.com/>
Email: uniqueinnovations@gmail.com