

ES-303G User Manual

Pin Number / Smart Key

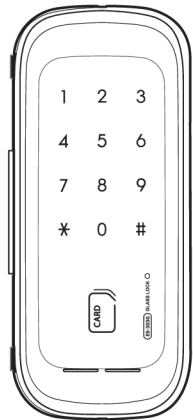

Left & Right hand Automatic Recognition type Glass Door Lock

Easy to install due to
automatic recognition
of left and right position

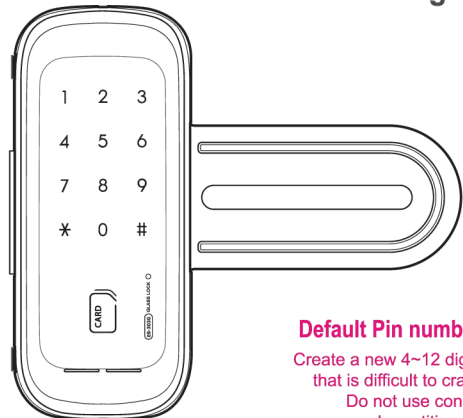

Default Pin number is 1,2,3,4

Create a new 4~12 digits Pin number
that is difficult to crack or guess.
Do not use consecutive
and repetitive number.

REV.02

Product Components

[Out-Body Part]

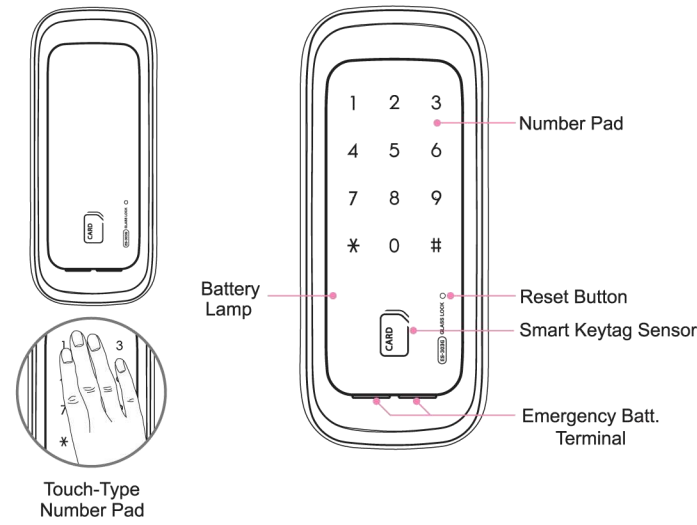

[In-Body Part]

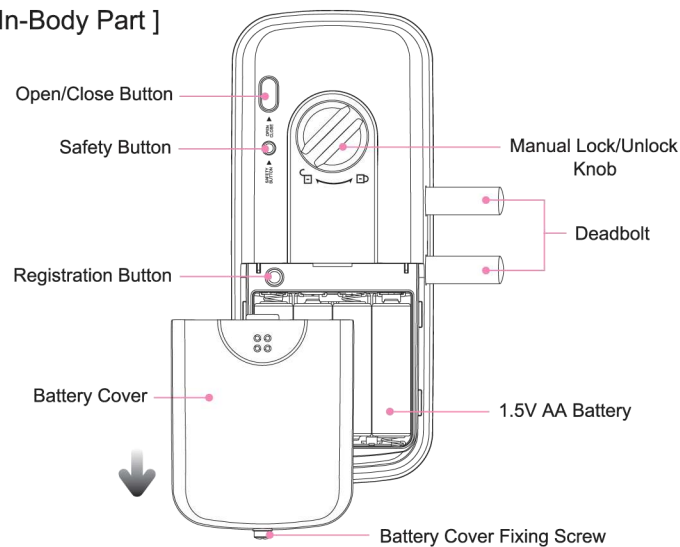

User's Guide
Trace form
Batteries (LR6 AA) 4EA

Smart key (Sticker) 2EA
Screw

2

Pin Number Registration

※To change existing pin number Default pin number upon purchase is [1, 2, 3, 4]

- ① Open the [Battery Cover]
Press [Registration] button once
- ② Enter current pin number
followed by [*] button.
- ③ Press number 1 button.
- ④ Enter new pin number to be
registered 4~12 digits.
Press [*] button.



Caution

After pressing Registration button, pin number should
be entered within 10 seconds or the registration
will be cancelled. New registration (steps ①, ②, ③, ④)
will delete all previously registered pin on the lock.

Only 1 set of Pin Number can registered.

Smart Keys Registration (Normal)

- ① Open the [Battery Cover]
Press [Registration] button once.
Enter current pin number
followed by [*] button.
- ② Press number 2 button.
- ③ Place smart cards to be
registered on the Card sensor
(A beep sound will signal
registration of each card)
- ④ Press [Registration] button after
cards has been registered.
And the registration is complete.



Beep~

Up to 100 Smart keys can be registered.
To register multiple smart key, repeat step ③ before the number pad turns off.
Press [Registration] button to complete

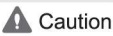

Caution

When registering additional smart key,
the existing registered card cannot be deleted.
If you want to delete it, please delete all cards then register.

3

Smart Keys Registration (Individual)

- ① Press [Registration] button once
Enter current pin number
followed by [*] button.
- ② Press number 2 button.
- ③ Enter the card location number
consisting of 3 digits from (001~100),
followed by the [#] button.
- ④ Place the card to be registered on the sensor.
The beep sound will be heard, and the saved
3 digit location number will be displayed on the
number pad.
- ⑤ If you want to register additional Smart Card
repeat step 4 Press [Registration] button
when complete.

Smart Keys Deletion (Individual)

- ① Press [Registration] button once
Enter current pin number
followed by [*] button.
 - ② Press 8 button, followed by [#] button.
Enter the registered card location number,
followed by [#] button.
 - ③ After deletion is complete,
all numbers are lighted on the number pad
Additional card deletion is in standby mode.
- If there is no location number to be deleted,
Press [*] button or [Registration] button.

Guest Pin Number Registration

- ① Press [Registration] button once
Enter current pin number
followed by [*] button.
- ② Press number 3 button.
- ③ Enter new Guest Pin Number to be
registered 4~12 digits
Press [*] button on the number pad
a melody will be heard, and the registration
is complete



Caution

THE GUEST PIN NUMBER IS FOR 1 TIME ENTRY ONLY



Note

WHEN REGISTRATION MODE IS CANCELLED
OLD PIN NUMBER WILL BE RESTORED
NEW REGISTRATION WILL DELETE OLD REGISTERED
PIN NUMBER

5

Smart Keys Deletion (All-at-once)

- ① Press [Registration] button once
Enter current pin number
followed by [*] button.
- ② Press number 8 button.
- ③ Long Press [#] button for 5 seconds
When the melody is heard,
All smart cards are deleted.

4

Opening Door Outside

Method 1 Opening by Pin number

- ① Touch the number pad
- ② Enter [Pin number] and Press [*] button
- ③ After the melody is heard, the door will open

Opening with Random Number Feature

- PROCEDURE -

(Before) Enter any random number + Enter Pin number + [*] button.
(After) Enter Pin number + Enter any random number + [*] button.
Either way, when the melody is heard. The door open.



Note

Random number feature is the random set of numbers
that is added before or after the original pin number is entered.
It is used to prevent the pin number from being exposed.
Including the pin number up to 20 digits only can be entered
During authentication with random number.



Caution

When Multi-touch feature is enabled. After entering pin number,
3 digit random number will be displayed on the screen,
press the 3 numbers, followed by [*] button and the door will open.
When Multi-touch feature is enabled.
The "Random Number Feature" is disabled.
The "Random Number Feature" is enabled in default upon purchase.

Method 2 Opening by Smart Key

- ① During Automatic Detection Mode
Place registered smart key on sensor
Melody will be heard and the door will open

- ② During Manual Detection Mode
Touch the number pad,
check if the number pad lights up,
place registered smart key on the sensor
Melody will be heard and the door will open.

Closing Door Outside

Method 1 Automatic Lock Mode

The door will lock automatically
After 2 seconds of closing the door

Method 2 Manual Lock Mode

- ① Touch the number pad and the door will lock



Setting

Enter Pin number → Press [*] button thrice → 1

- ② Press [#] button and the door will lock



Setting

Enter Pin number → Press [*] button thrice → 2

6

Opening Door Inside

Method 1 Normal Mode

While door is locked
Press (Open/Close) button
And the door will open

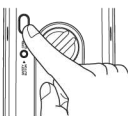

Method 2 Safety Lock Mode

While door is locked
Press [Safety] button
Then Press (Open/Close) button
And the door will open

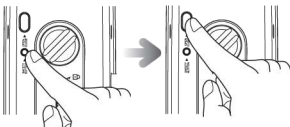

Method 3 Manual Lock Mode

While door is locked
Turn the [Manual Lock Knob]
To [Open] direction
And the door will open

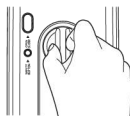

Closing Door Inside

Method 1 Automatic Lock Mode

The door will automatically lock
After 2 seconds of closing the door



Method 2 Manual Lock Mode

After closing the door
Press (Open/Close) button
And the door will lock

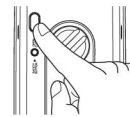

Method 3 Closing the door manually

After closing the door Turn the [Manual Lock Knob]
To [Close] direction And the door will lock



Force Lock Setting (Outside Force Lock)

This security setting will disable the use of [Open/Close] button inside

Setting

- While the door is closed
Touch the number pad
Enter Registered pin number
- Press [#] button, followed by [0] button

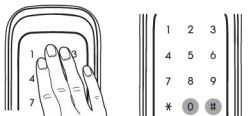

Cancellation

Open the door using Manual Lock / Unlock lever
and force lock setting will be cancelled

7

Force Lock Setting (Inside Force lock)

This security setting will not allow any forms of entry from outside
(Pin Number and Smart Key)

Setting

While door is closed Press [Open/Close] button
for 3 seconds,When the confirmation tone is heard
The setting is complete



Cancellation

Open the door using Manual Lock/Unlock knob
or pressing [Open/Close] Button inside and
force lock setting will be cancelled



Sound Volume Setting

This feature allows the user to adjust the operation sound volume per level.
(Perform while door is closed)

- Press number pad outside
Enter Pin number, Press [#] button
- Press [3] to increase sound
Press [6] to decrease the sound

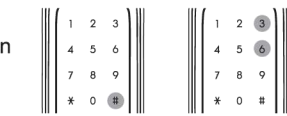

※ Sound can be adjusted up to 7 levels.

Sound Mute Setting

Touch external number pad, Press [#] button Enter Pin number
and the mute setting (Keypad tone and door operation tone)will
be mute This feature is 1 time operation only



When Sound Mute is set, when you enter a number on the number pad,
it will be blinking. This is 1 time operation After 1 usage,
the sound will come back to normal

Auto / Manual Lock Mode Setting

※Set the door to automatic or manual lock mode.

- Automatic Lock Mode



- Manual Lock Mode



In manual lock mode, the door will not lock after closing the door.
To lock inside, Press [Open/Close] button or Touch the number pad
outside, Enter [#] button and the door will lock
※ During purchase of item the Manual Lock Number Pad is set in default

8

Dual-Mode Security Feature Setting

※ The Pin Number & Smart Key should be registered
first before setting this feature.

- Press [Registration] button for 5 seconds
The entire LED will light up
After 3 seconds the alarm will stop
And after 2 seconds it will be on again.

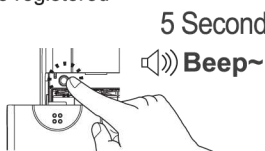

- Enter current user password.
When you press [*] button,
The front panel LED will blink and light-up.

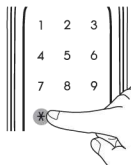

- Press [1] button to Turn-Off Dual-Mode Security
Press [3] button to Turn-On Dual-Mode Security.

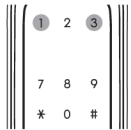

During Dual-Mode Security Setting,
when the confirmation sound is heard,
everything will be turned-off

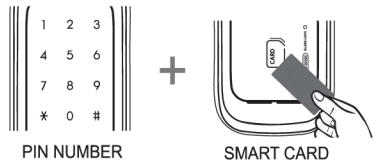

Home Network Modul & Remote Control Setting

Registration

- Press [Registration] button Enter pin number
Followed by [*] button
- Home Network Module / Remote Control
Registration
Press [Registration] button /
Press [Open] button

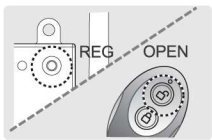
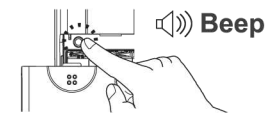

※ For registration of additional remote control Repeat step number 2
Up to 5 remote controls can be registered

Deletion

- Press [Registration] button Enter pin number
Followed by [*] button

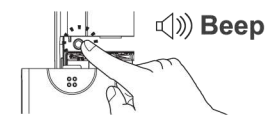

- Press [0] button

- Press [#] button for 5 seconds
When the melody is heard
Deletion is complete

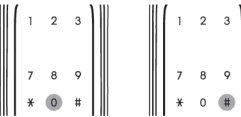

10

Melody Settings

- Touch the number Pad,
Enter Pin Number
Press [#] button for 3 times

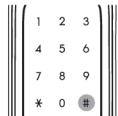

- Select from the menu
press [7] to turn off melody
press [8] to decrease,
press [9] to increase

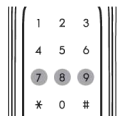

- This will function in manual lock mode only
- After the melody is heard and the door is not closed
but a new function is performed the melody will be off
- After the door was opened the melody will not be heard

Deadbolt Jammed Alarm

- During open and close operation
if the detection sensor is not working
an error sound will be heard
- This will retry for up to 3 times

Replace battery alarm

During normal operation, and a series of alarm is heard.
it indicates the need for battery replacement.
Please replace all battery with new ones at this time.



Please replace all batteries all-at-once.
Do not mix new and old batteries.
Do not mix batteries of different brand.

Emergency Battery

When the batteries run out, the door can be opened using emergency battery.
(9V battery is purchased separately)

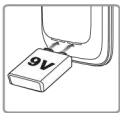

- Place battery on the 9v battery terminal
- Press the [*] button
- Enter the [Pin number]
- Press the [*] button again and the door will open

11

Smart Key Auto / Manual Detection Setting

Sets the Smart key detection to Auto or Manual mode

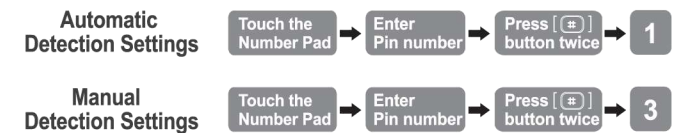

- In Manual Mode, Touch the number pad,
Place the Smart key on the sensor and the door will open.
- In Automatic Mode, Place the Smart key on the sensor and the door will open.
- Automatic Mode is enable in default.

Normal & Safe open Mode Setting

When you purchase the product for the first time, it is set in normal mode

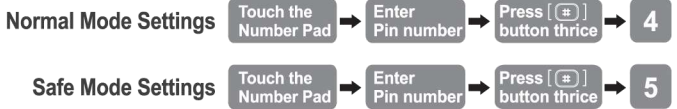

Normal Mode Settings

- You can open the door by pressing [OPEN / CLOSE] button inside

Safe Mode Settings

- You can open the door by Pressing [Force Lock] button then
press the [OPEN / CLOSE] button within one second

※ Pressing [Force Lock] button and [OPEN / CLOSE] button continuously
This enhances the security unlock feature

Multi-Touch Safe Feature Setting

Multi-touch Safe Feature is the security feature that enables user to enter
additional series of number after entering pin number. It erases fingerprint
traces left on the number pad & protects the pin number from being exposed.

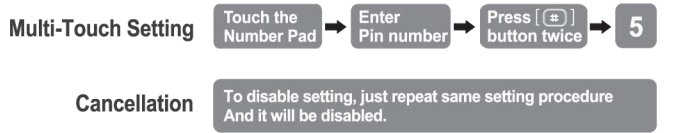

Cancellation

To disable setting, just repeat same setting procedure
And it will be disabled.



When multi-touch security is enabled, after entering pin number,
Press the 3 random number that is displayed on the screen.
Press [-] button and the door will open.
When Multi-touch Security feature is enabled "Random Number"
feature is disabled And when "Random number" feature is enabled.
Multi-touch Security Feature is disabled.

9

Anti-Hacking (invasion) Alarm

When the lock detects forceful entry from inside or outside,
It will activate a series of alarm.

Cancellation

Remove the batteries or enter the registered pin or card
and the alarm can be cancelled.

Fire Sensor Alarm

When the inside temperature rises to (62℃±5℃),
the lock will generate an alarm and automatically unlocks the door.



Prolonged exposure of the main body to direct sunlight can activate
fire sensor alarm.
Even in 'Force Lock' status, the door will automatically open.
When temperature returns to normal. The lock will return to it's normal
operation status.

Anti-Prank Alarm & 1 Minute Lock

5 consecutive failed Pin number and Smart keytag entry will activate
an alarm. And the lock will not function for 1 minute.

Product Dimension

Item		Specifications
Installation	tempered glass door	Glass door thickness 12mm
Authentication Method	Pin number	4~12 Digits
	Smart Key	Up to 100 Keys can be registered
Rated voltage	DC 6V	LR6 1.5V AA size Alkaline Battery 4 PCS
Emergency Batt	DC 9V	Alkaline Battery (Sold Separately)
Product Type	Non fire proof, Temp.Sensor, Non-key, Sub type door lock (D-NF-T-NK-S)	
Temp. Sensor	Heat Sensor type	72℃±5℃ (Testing Room)
		62℃±5℃ (Normal Environment)
Material	Outbody : Al, Zn, ABS	Inbody : Zn, ABS

RF Specification

Item	Frequency	Channel	Modulation Type	Antenna Power
RFID	13.56MHz	1 PC	ASK	93.5dBuV/m@10m below
Remote Device	447.275MHz	1 PC	FSK	10mW below

12